

(A) MINIMUM REQUIRED CONDUIT—TYPICAL DETAIL
SCALE NONE

SYMBOLS

- | | |
|-----|---|
| M | EQUIPMENT INTERFACE MODULE (DIV 23). MOUNT MODULE IN ACCESSIBLE LOCATION ON HORIZONTAL WALL NEAR ASSOCIATED FAN UNIT. |
| T | THERMOSTAT OUTLET (DIV 26) |
| RIG | RIG MODULE (DIV 23) |
| CO2 | CO ₂ SENSOR (DIV 23) |
| ZP | ZONE PANEL (DIV 23) |
| Z* | ZONE DAMPER (*=ZONE NUMBER) |
| EIM | EQUIPMENT INTERFACE MODULE (ECONNECT) |
| EC | THERMOSTAT (ECONNECT) |

NOTE:
ALL TEMPERATURE CONTROL CONDUIT SHALL
BE FURNISHED AND INSTALLED BY DIVISION 26.

NOTE:
RIG's MUST INSTALLED AT LEAST 2'-0" AWAY
FROM ALL ELECTRICAL DEVICES: I.E. MOTORS,
LIGHTS, ELECTRIC WATER HEATERS, ETC.

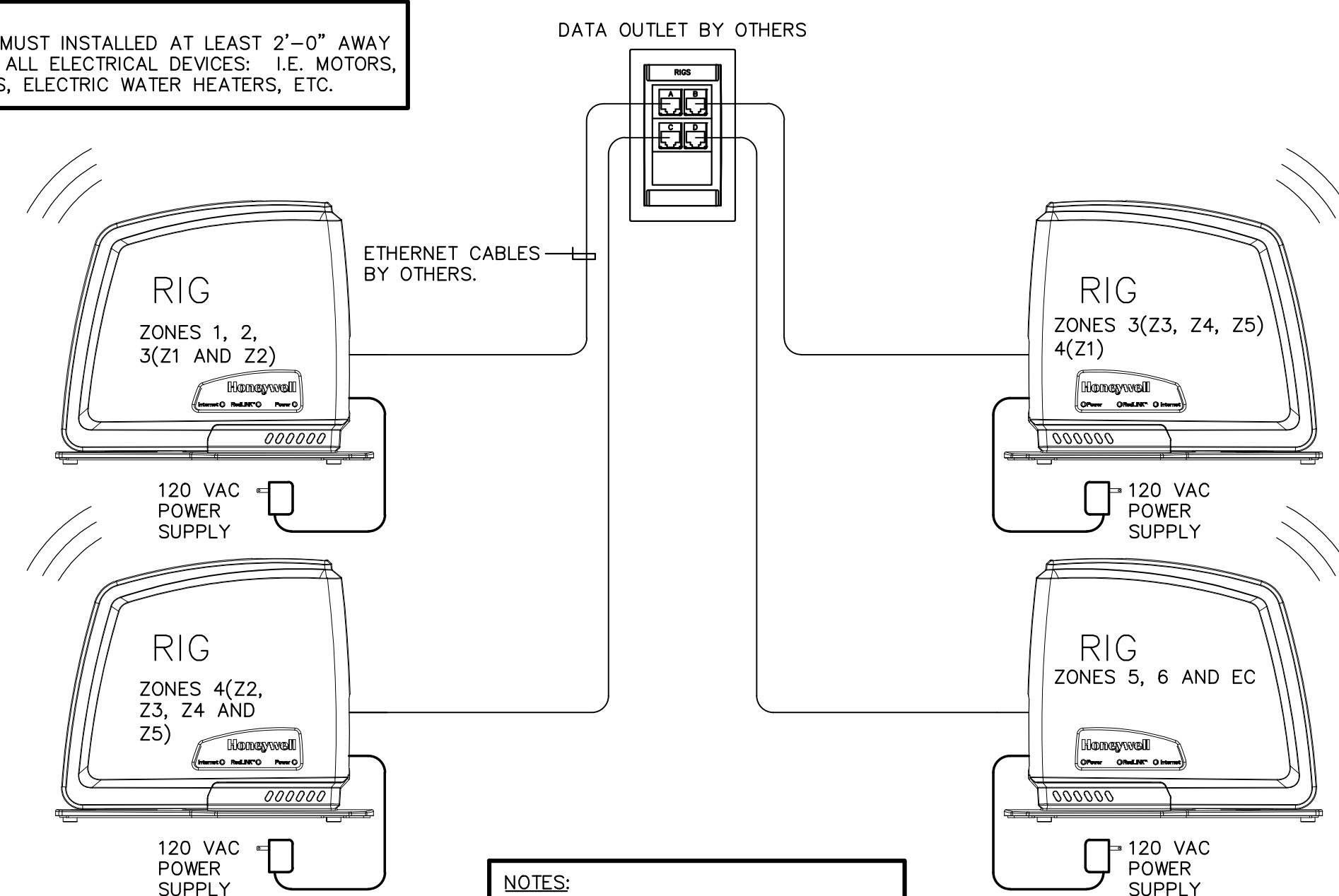

- NOTES:**
1. ETHERNET CABLE MAY REQUIRE LENGTHS UP TO 100 FEET.
 2. ALL CONTROL DEVICES MUST BE INSTALLED AT LEAST 2'-0" APART.
 3. PROVIDE MULTIPLE OUTLET POWER STRIP FOR RIG'S. A MINIMUM OF ONE OUTLET FOR EACH RIG.

RIG WIRING DIAGRAM

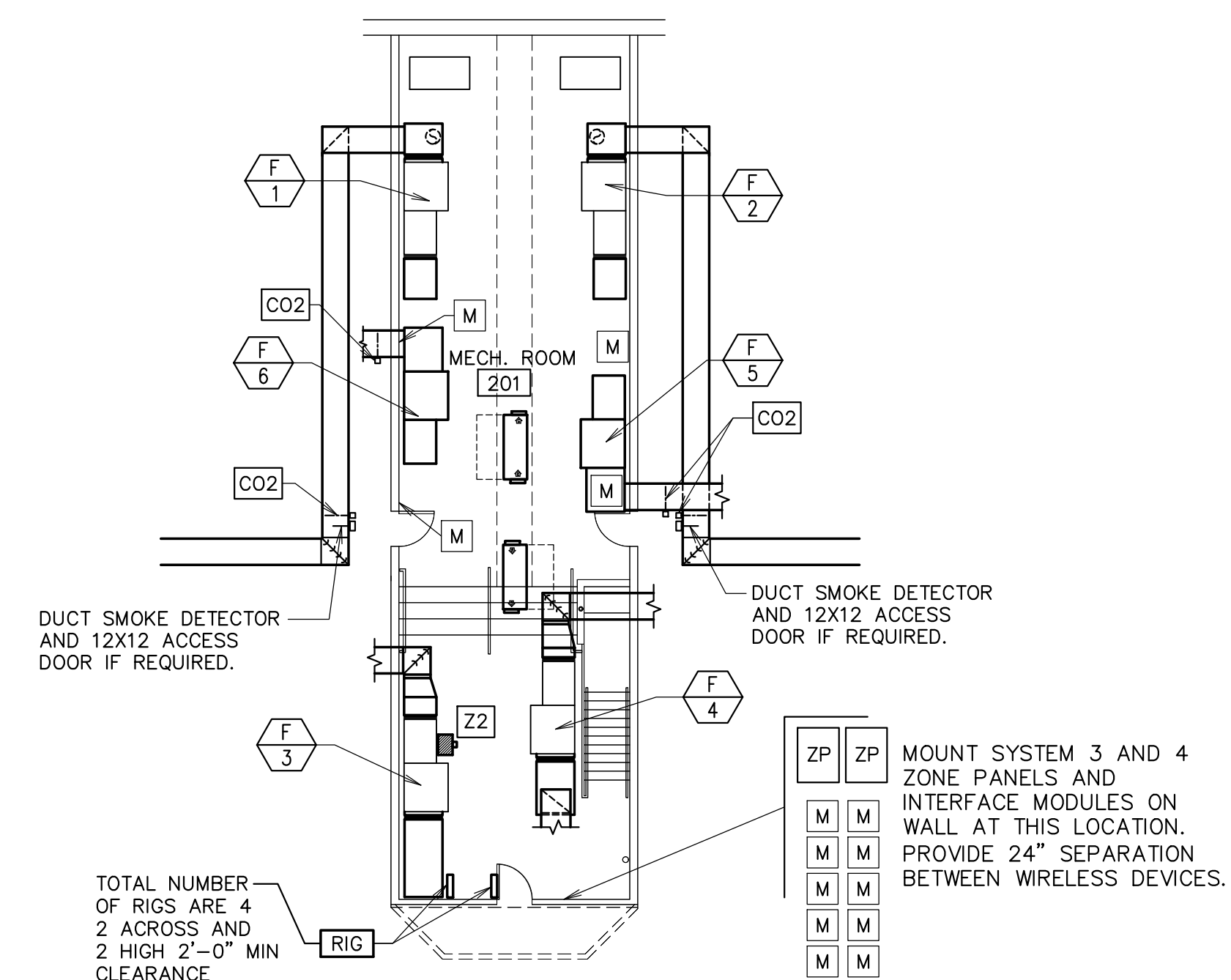

TEMPERATURE CONTROL
EQUIPMENT PLATFORM PLAN

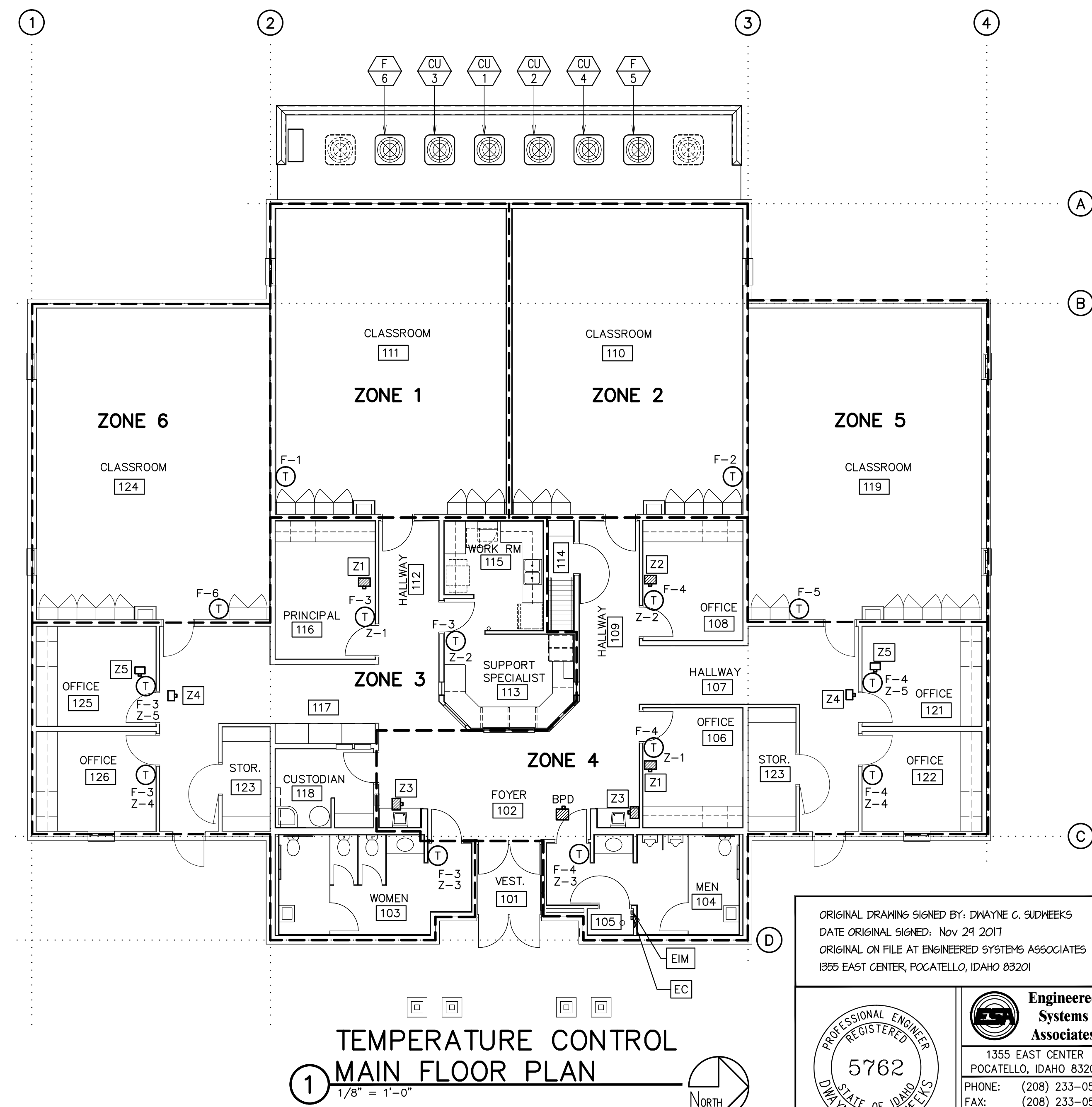

ORIGINAL DRAWING SIGNED BY: DWAYNE C. SUDWEEKS
DATE ORIGINAL SIGNED: Nov 29 2017
ORIGINAL ON FILE AT ENGINEERED SYSTEMS ASSOCIATES
1355 EAST CENTER, POCATELLO, IDAHO 83201



	Engineered Systems Associates
	1355 EAST CENTER POCATELLO, IDAHO 83201
	PHONE: (208) 233-0501 FAX: (208) 233-0529 EMAIL: esa@engsystems.com
	ESA JOB NUMBER: 17011
	1997

n b w architects p.a.

ARCHITECTURE / PLANNING / INTERIORS

SCOTT, NELSON, AIA, KEVIN R. BOOBY, AIA, JAMES H. WYATT, AIA,
990 JOHN BURNS PARKWAY P.O. BOX 2212 - IDHO FALLS, IDHO 83402-2212
(P) 208-522-8779 (F) 208-522-8785 (W) www.nbwarchitects.com

tamp:

New Building for:
Thunder Ridge Sr. Seminary
S&I
Project
Address

Project for:

THE CHURCH OF
JESUS CHRIST
OF LATTER-DAY SAINTS

[illegible]

Project Number:
6059

Plan Series:
EM07-04-10

Property Number:
**

Sheet Title:
**AUTOMATIC
TEMPERATURE
CONTROL
FLOOR PLANS
AND DETAILS**

Sheet:

ME101